

DIEHL ROAD

MILL ST.

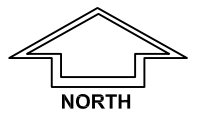
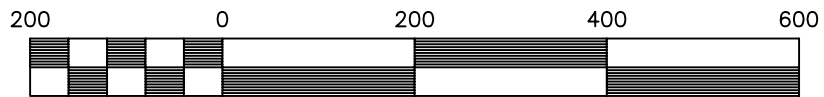
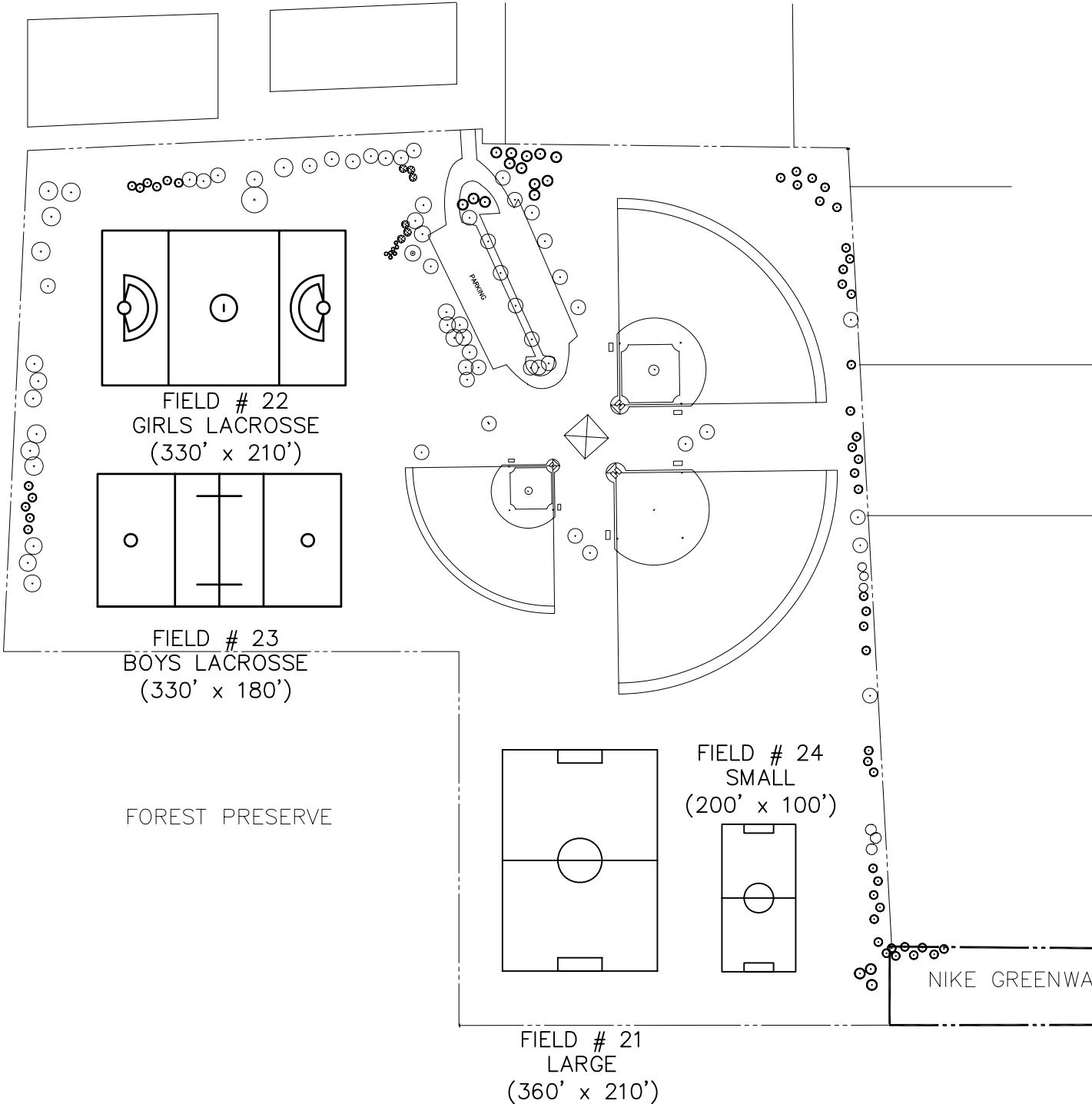

SHEET NO.	
SCALE	1" = 200'
DATE	Spring 2008
PROJECT ID	
DRAWN BY	MP
CHECKED BY	BA

DATE	REVISIONS

Field Location Map

NIKE SPORTS COMPLEX
288 W. DIEHL RD
NAPERVILLE, IL



NAPERVILLE PARK DISTRICT

Administrative Office
320 W. Jackson
Naperville, Illinois
60540-5275

Project Manager: Brock Atwell
Telephone 630/848-3534
E-Mail batwell@napervilleparks.org
Fax 630/848-5001