

DIEHL ROAD

MILL ST.

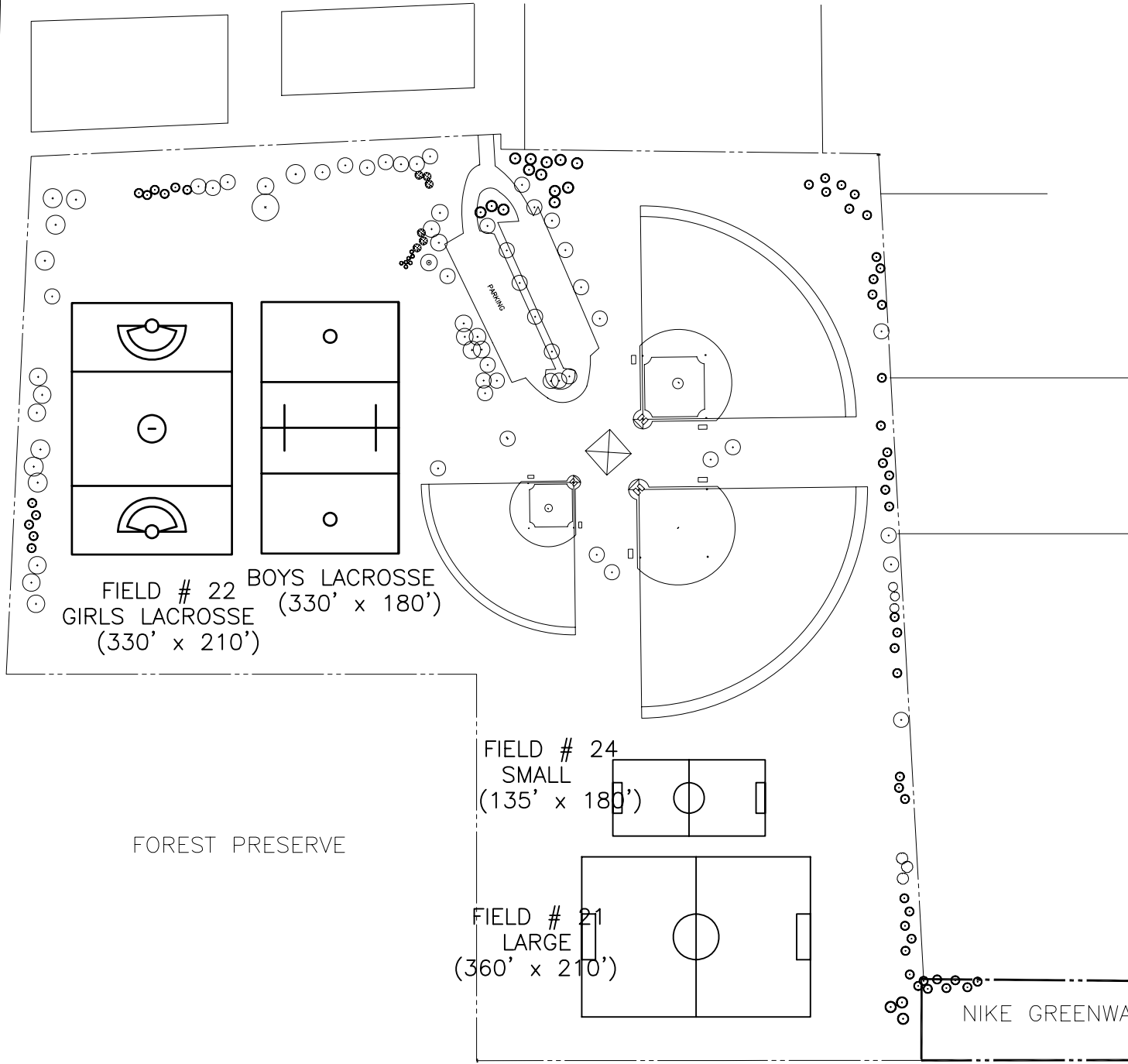

FIELD # 22 BOYS LACROSSE (330' x 180')
 GIRLS LACROSSE (330' x 210')

FIELD # 24
 SMALL (135' x 180')

FIELD # 21
 LARGE (360' x 210')

FOREST PRESERVE

NIKE GREENWAY

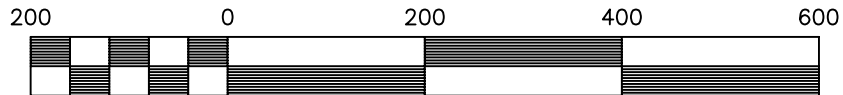

Field Location Map

NIKE SPORTS COMPLEX
 288 W. DIEHL RD
 NAPERVILLE, IL



NAPERVILLE PARK DISTRICT

Administrative Office
 320 W. Jackson
 Naperville, Illinois
 60540-5275

Project Manager: Brock Atwell
 Telephone 630/848-3534
 E-Mail batwell@napervilleparks.org
 Fax 630/848-5001

SHEET NO.	SCALE	1" = 200'
	DATE	Fall 2009
	PROJECT ID	
	DRAWN BY	MP
CHECKED BY	BA	
DATE	REVISIONS	